



Amawaterways AmaCerto



This 164-passenger vessel incorporates the most advanced design offering spacious staterooms featuring our exclusive twin balconies, multiple dining venues, heated pool, interned/Wi-Fi access and more.

Inspired by classic ocean yachts, the AmaCerto -- debuted in 2012 -- will provide the most distinctive river cruise experience. A magnificent glass elevator is one of the unique design elements found onboard, as well as our exclusive "Twin Balconies". The beautifully-decorated and spacious accommodations range in size up to 300 sq. ft. Relax in a heated Sun Deck swimming pool with a "swim-up" bar; enjoy Chaîne des Rôtisseurs culinary creations. The ship also features a Fitness Center, Massage, Hair and Beauty salon; complimentary Internet access and first-run Hollywood movies; plus a fleet of bicycles to enhance your river cruise experience.

Built in 2012 in the Netherlands
 Length 443 ft., width 38 ft.
 Crew 49 (European)
 Staterooms 79, suites 3
 Registry Switzerland, homeport Basel

Deckplan:

Enchanting Rhine - 8 days
 Amsterdam, Köln, Basel ...



Tell a friend:



 Send this URL

 Print this page

 [Download this page in pdf](#)

Categories

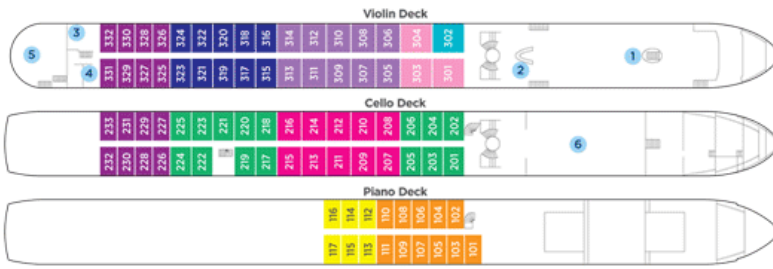

Comfort	
Comfort Plus	
Premium	
Premium Plus	
Deluxe	

For a larger deck plan please visit www.AmaWaterways.com

Suite	Violin Deck French & Outside Balcony - 300 sq. ft.
Cat. AA+	Violin Deck French & Outside Balcony - 290 sq. ft.
Cat. AA	Violin Deck French & Outside Balcony - 235 sq. ft.
Cat. AB	Cello Deck French & Outside Balcony - 235 sq. ft.
Cat. BA	Violin Deck French & Outside Balcony - 210 sq. ft.
Cat. BB	Cello Deck French & Outside Balcony - 210 sq. ft.
Cat. C	Violin & Cello Deck French Balcony - 170 sq. ft.
Cat. D	Piano Deck Fixed Window - 160 sq. ft.
Cat. E	Piano Deck Fixed Window - 160 sq. ft.

Note: Cat. AA+ stateroom has a modified layout

Deck Plan

- 1 Main Lounge
- 2 Reception
- 3 Fitness Room
- 4 Massage & Hair Salon
- 5 The Chef's Table restaurant
- 6 Main Restaurant

Technical Data

Built: AmaVista, AmaSerena - 2015
 AmaSonata, AmaReina - 2014
 AmaPrima - 2013
 AmaCerto - 2012
 Length: 443 ft.
 Width: 38 ft.
 Crew: 49
 Staterooms: 82
 Passengers: 164
 Registry: Switzerland

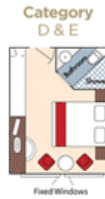
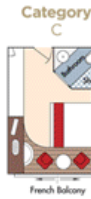
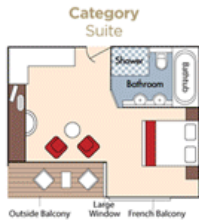

Welcome
 Film
 Contact
 Ships

Danube
 Rhine, Moselle & Main
 Rhône, Saône & Seine
 Elbe
 Wolga & Dnepr
 Douro
 Christmas & New Year Cruises

Promotions
 Seacruises

Brochure
 Contact
 Terms & Conditions (NL + FR)

