



## Amawaterways AmaPrima



This 164-passenger vessel incorporates the most advanced design offering spacious staterooms featuring our exclusive Twin balconies, multiple dining venues, heated pool, interned/Wi-Fi access and more.

Inspired by classic ocean yachts, the AmaPrima provide the most distinctive river cruise experience. A magnificent glass elevator is one of the unique design elements found onboard, as well as our exclusive "Twin Balconies". The beautifully-decorated and spacious accommodations range in size up to 300 sq. ft. Relax in a heated Sun Deck swimming pool with a "swim-up" bar; enjoy Chaîne des Rôtisseurs culinary creations. The ship also features a Fitness Center, Massage, Hair and Beauty salon; complimentary Internet access and first-run Hollywood movies; plus a fleet of bicycles to enhance your river cruise experience.

Built in 2013 in the Netherlands  
 Length 443 ft., width 49  
 Crew 49 (European)  
 Staterooms 79, suites 3  
 Registry Switzerland, homeport Basel

### Deckplan:

Romantic Danube - 8 days  
 Passau - Wenen - Budpest ...



Tell a friend:

Send this URL

Categories

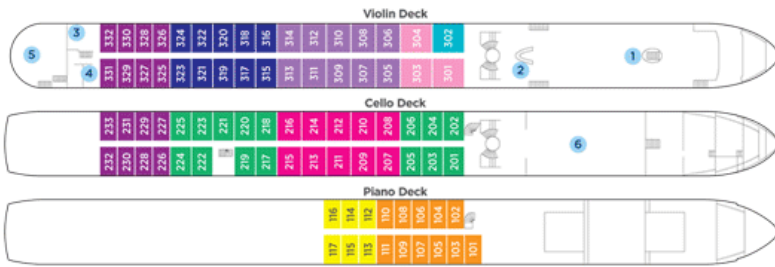

Comfort	
Comfort Plus	
Premium	
Premium Plus	
Deluxe	

For a larger deck plan please visit [www.AmaWaterways.com](http://www.AmaWaterways.com)

Suite	Violin Deck French & Outside Balcony - 300 sq. ft.
Cat. AA+	Violin Deck French & Outside Balcony - 290 sq. ft.
Cat. AA	Violin Deck French & Outside Balcony - 235 sq. ft.
Cat. AB	Cello Deck French & Outside Balcony - 235 sq. ft.
Cat. BA	Violin Deck French & Outside Balcony - 210 sq. ft.
Cat. BB	Cello Deck French & Outside Balcony - 210 sq. ft.
Cat. C	Violin & Cello Deck French Balcony - 170 sq. ft.
Cat. D	Piano Deck Fixed Window - 160 sq. ft.
Cat. E	Piano Deck Fixed Window - 160 sq. ft.

Note: Cat. AA+ stateroom has a modified layout

**Deck Plan**

- 1 Main Lounge
- 2 Reception
- 3 Fitness Room
- 4 Massage & Hair Salon
- 5 The Chef's Table restaurant
- 6 Main Restaurant

**Technical Data**

Built: AmaVista, AmaSerena - 2015  
 AmaSonata, AmaReina - 2014  
 AmaPrima - 2013  
 AmaCerto - 2012  
 Length: 44.3 ft.  
 Width: 38 ft.  
 Crew: 49  
 Staterooms: 82  
 Passengers: 164  
 Registry: Switzerland

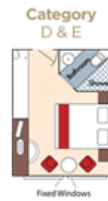
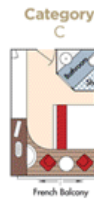
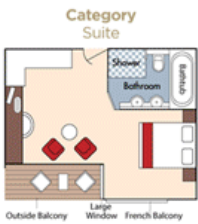

Welcome  
 Film  
 Contact  
 Ships

Danube  
 Rhine, Moselle & Main  
 Rhône, Saône & Seine  
 Elbe  
 Wolga & Dnepr  
 Douro  
 Christmas & New Year Cruises

Promotions  
 Seacruises

Brochure  
 Contact  
 Terms & Conditions (NL + FR)

